

LumiPano™ Lite Collection

AURORA

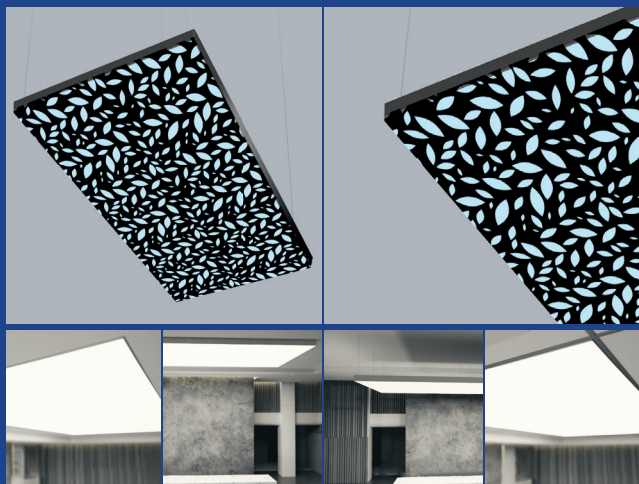

Spec by:

Agency:

Project Name:

Type of Project:

Notes:



IP22
RATED



LIGHTING PERFORMANCE*

	Output	Size					
		2' x 2'	2' x 4'	4' x 4'	8' x 4'	10' x 6'	12' x 8'
Power consumption (Watts)	Premium	25.6W	57.6W	129.6W	288W	560W	912W
Delivered output (Lumens)		615 lm	1384 lm	3114 lm	6921 lm	13457 lm	21915 lm

* Power consumption and delivered output values are based on 6500K and on diffuser without a pattern.

ORDERING CODE

TLS	LPL Product	AU Engine	Rating	Size	Mounting
TLS	LumiPanoLite LPL	Aurora AU	Indoor IN Outdoor OUT	2' x 2' 2x2 2' x 4' 2x4 4' x 4' 4x4 8' x 4' 8x4 10' x 6' 10x6 12' x 8' 12x8	Recessed RD Surface SF Suspended SP Wall WL

Frame color	CCT	Output*	Control	Diffuser	Standard Patterns*
Black BL White WH Clear Anodized CA	4000K 40K 6500K 65K	Premium (746 lm/sqf)* P	DMX by TLS DMXT DMX by others DMXO	LightTex Pano White LPW LightTex Pano Black LPB LightTex Pano Silver LPS	Fall FL Hive HV LightSpeed LE Maze MZ Mondrian MD StarStream SS Custom Design CD

* Lm/sqf are calculated at LED source

* See page 06



TECHNICAL SPECIFICATIONS

■ Diffuser

	Light Tex Pano	Light Tex Pano Black	LightTex Pano Silver
Material	PVC	100 % Polyester	100 % Polyester
Weight	175 gr/m2 (18 gr/ft2)	175 gr/m2 (18 gr/ft2)	175 gr/m2 (18 gr/ft2)
Fire classification	NFPA-701, B1, EN 13501-1, B-s1, d0	NFPA-701, B1, EN 13501-1, B-s1, d0	NFPA-701, B1, EN 13501-1, B-s1, d0
Transmission rate	29%*	N/A	N/A
CCT shift	0-50K	0-50K	0-50K
NRC	0.82	0.82	0.82

*Without any pattern

■ Frame color

Material	Aluminum		
Standard colors	Black 	White 	Clear Anodized 

■ Lighting

Ingress protection	IP22 (indoor) IP65 (outdoor)
CRI	> 90 (white LED)
LM80 *	> 36,000 hours
Operating temperature	-30 °C TO 80 °C

Note: *LM80 Test is only applicable to white pixels.

Warranty*	5-year limited warranty for LED
------------------	---------------------------------

* Warranty Terms and Conditions at www.tls-led.com/warranty

SIZES PREMIUM

2'x2'

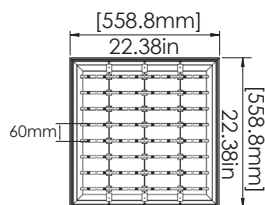

2'x4'

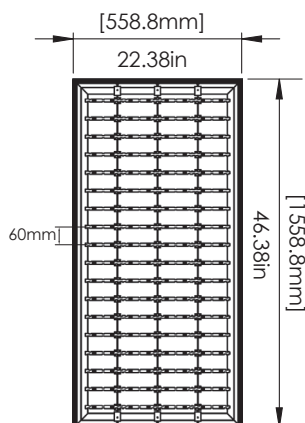

4'x4'

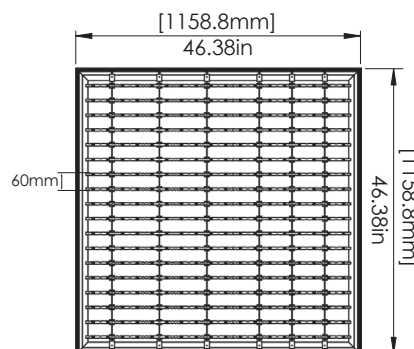

8'x4'

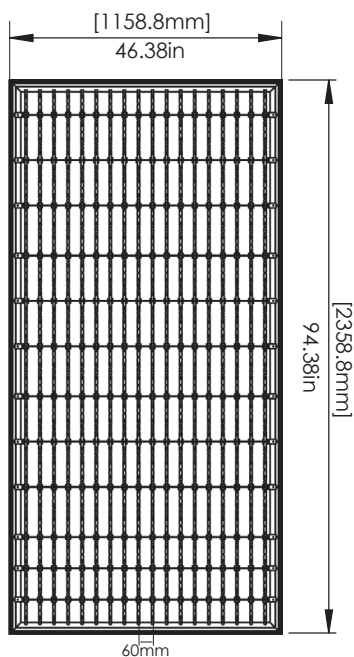

10'x6'

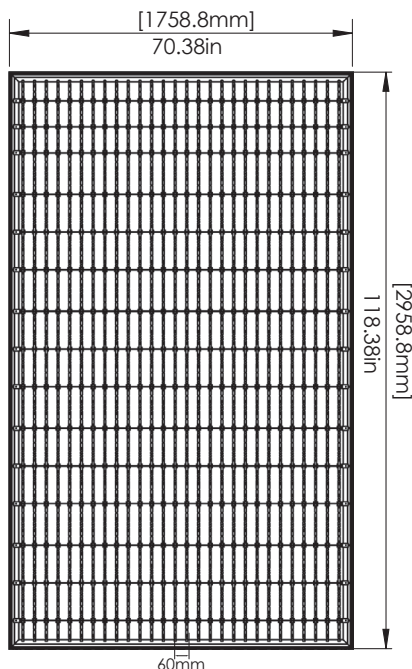

12'x8'

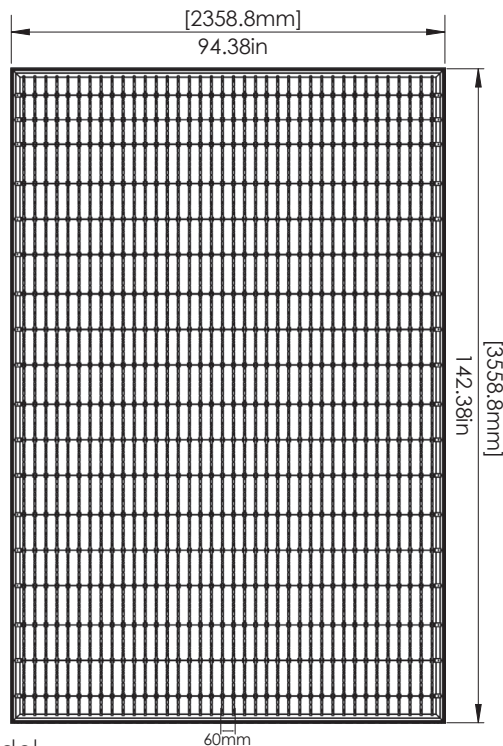

Note: Custom dimensions are available with LumiCloud™ Bespoke model.

■ Weight Premium

Size	2'x2'	2'x4'	4'x4'	8'x4'	10'x6'	12'x8'
Kg	13	17	22	34	60	72
Lbs	28	38	49	74	133	154

Variations may occur but will never exceed indicated values.

LIGHTING PERFORMANCE AND EFFICIENCY

■ Light transmission

Patterns	Percent of Perforation	Output
Fall	31%	191
Hive	37%	228
LightSpeed	24%	148
Maze	33%	203
Mondrian	16%	98
StarStream	13%	80

*Lumens are calculated for 4"x4" fixture. Pattern will decrease the lumen output.

MOUNTING OPTIONS

Recessed (RD)

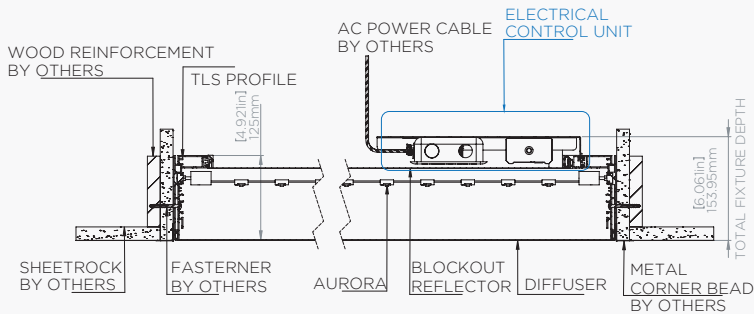

- Cavity to be 1/8" (3mm) over nominal
- Cavity to be minimum 7" (177.8mm) deep

Surface (SF)

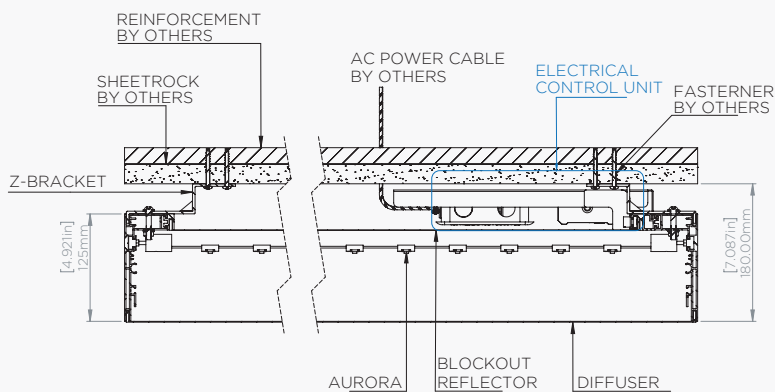

Suspended (SP)

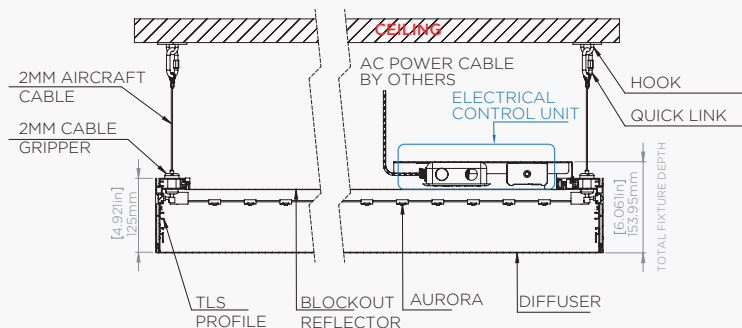

- Hooks to existing ceiling installed by others

Wall (WL)

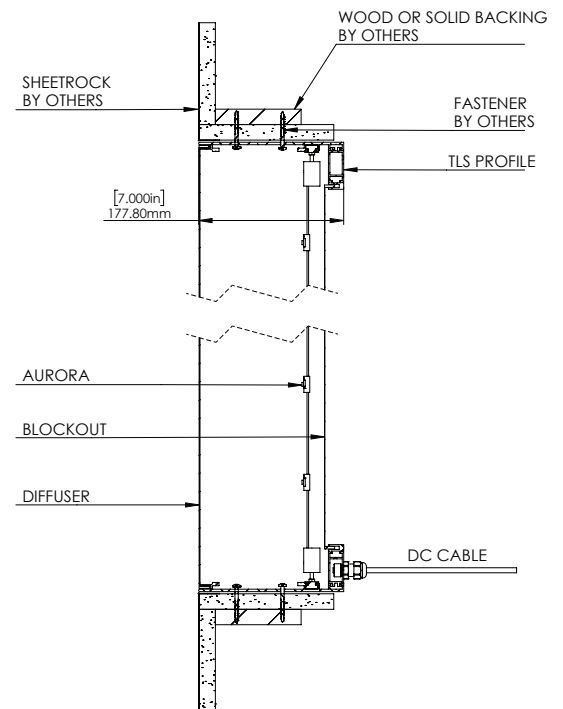

Wall Surface

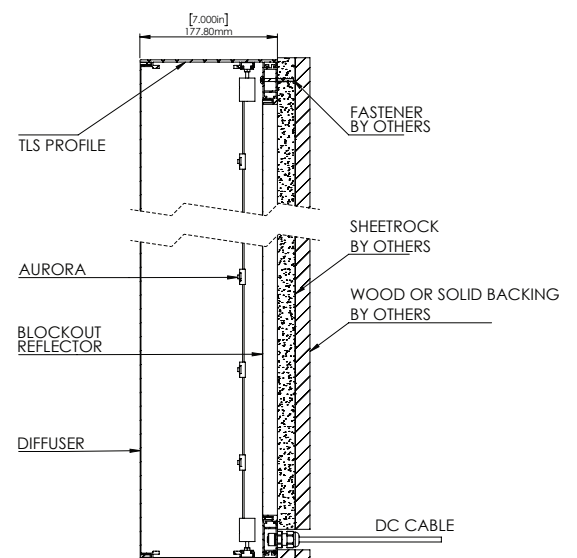

Note: Parts reference numbers are available upon request.

PATTERNS

■ Fall (FL)



■ Hive (HV)

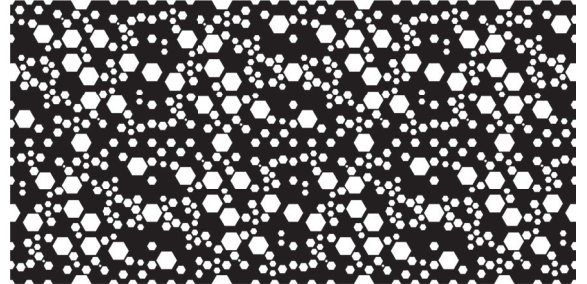

■ LightSpeed (LE)



■ Maze (MZ)

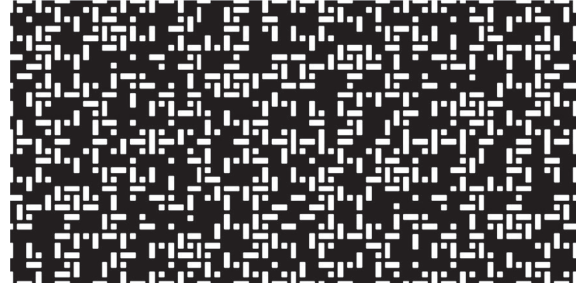

■ Mondrian (MD)

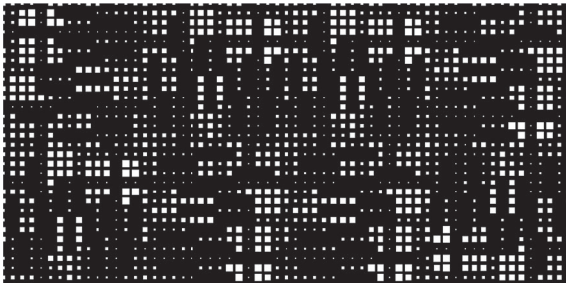

■ StarStream (SS)

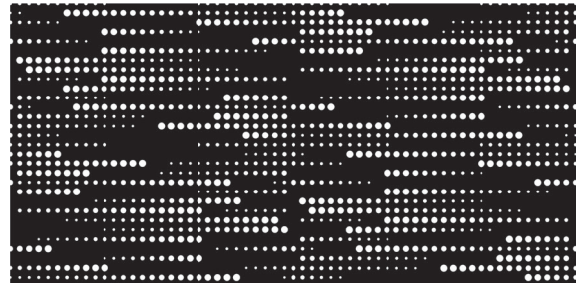

CONTROL

■ DMX by TLS (DMXT)

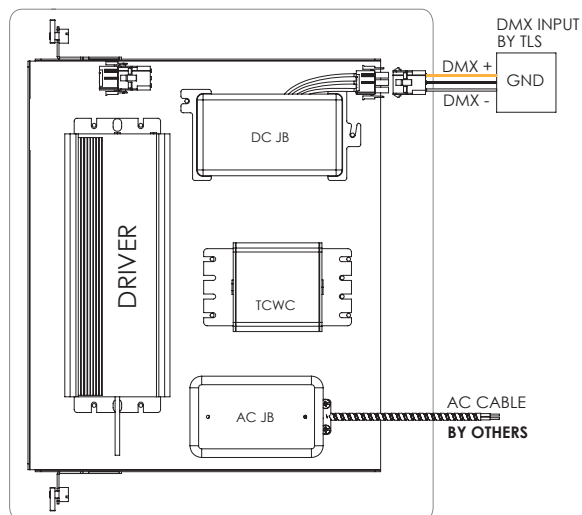

■ DMX by others (DMXO)

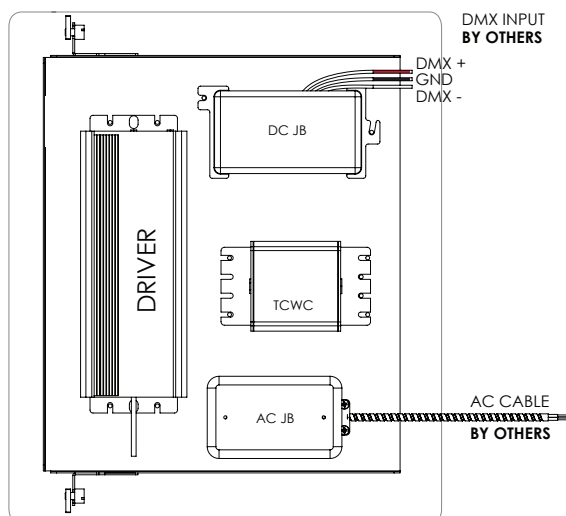

■ Electrical

Driver models	HLG-60-15A, HLG-100-15A, HLG-150-15A, HLG-240-15A, HLG-320-15A
Input voltage	90-305 V AC, 47-63 HZ
Output voltage	14-15 V DC